



**RESOURCE  
MANAGEMENT AGENCY  
COUNTY OF TULARE  
AGENDA ITEM**

**BOARD OF SUPERVISORS**

ALLEN ISHIDA  
District One

CONNIE CONWAY  
District Two

PHILLIP A. COX  
District Three

J. STEVEN WORTHLEY  
District Four

MIKE ENNIS  
District Five

**AGENDA DATE:** November 27, 2007

Public Hearing Required	Yes	<input type="checkbox"/>	No	<input checked="" type="checkbox"/>	N/A	<input type="checkbox"/>
Scheduled Public Hearing w/Clerk	Yes	<input type="checkbox"/>	No	<input checked="" type="checkbox"/>	N/A	<input type="checkbox"/>
Published Notice Required	Yes	<input type="checkbox"/>	No	<input checked="" type="checkbox"/>	N/A	<input type="checkbox"/>
Advertised Published Notice	Yes	<input type="checkbox"/>	No	<input checked="" type="checkbox"/>	N/A	<input type="checkbox"/>
Meet & Confer Required	Yes	<input type="checkbox"/>	No	<input checked="" type="checkbox"/>	N/A	<input type="checkbox"/>
Electronic file(s) has been sent	Yes	<input checked="" type="checkbox"/>	No	<input type="checkbox"/>	N/A	<input type="checkbox"/>
Budget Transfer (Aud 308) attached	Yes	<input type="checkbox"/>	No	<input checked="" type="checkbox"/>	N/A	<input type="checkbox"/>
Personnel Resolution attached	Yes	<input type="checkbox"/>	No	<input checked="" type="checkbox"/>	N/A	<input type="checkbox"/>
Resolution, Ordinance or Agreements are attached and signature line for Chairman is marked with tab(s)/flag(s)	Yes	<input checked="" type="checkbox"/>	No	<input type="checkbox"/>	N/A	<input type="checkbox"/>
CONTACT PERSON: Celeste Perez    PHONE: 559-733-6291						

**SUBJECT:** Initiate proceedings to form Assessment District No. 07-767R-VISALIA to pay for the continuing cost of maintenance of the public streets and roadways within Subdivision Tract No. 767 located north of the City of Visalia.

- REQUEST(S):**
- That the Board of Supervisors:
1. Initiate proceedings to form Assessment District No. 07-767R-VISALIA.
  2. Designate the County Engineer as the Engineer for the purpose of these proceedings.
  3. Direct the Engineer to prepare and file a report with the Clerk of the Board.

**SUMMARY:**

The Board has directed, in Resolution No. 2005-0519, that the County will require the formation of an assessment district for the maintenance of new public roadways resulting from land division and land development activities. Planning Commission Resolution No. 8160 approving the Tentative Map for Subdivision Tract No. 767 required the formation of a road maintenance assessment district as a condition precedent to recordation of the Final Map for Subdivision Tract No. 767. The Subdivider (Kap Su Davis) has requested the County form an assessment district to

**SUBJECT:** 07-767-VISALIA  
**DATE:** November 27, 2007

pay for maintenance of the public streets and roadways serving Subdivision Tract No. 767.

Subdivision Tract No. 767 is a division of 14.7 acres into 56 residential lots to be constructed in three phases with Phase I consisting of 22 lots located on the north side of Avenue 320 east of State Route 63, north of the City of Visalia.

Construction cost of the streets and roadway improvements will be borne by the Subdivider of Subdivision Tract No. 767. The cost of maintaining these improvements and administering this assessment district is proposed to be provided for by assessing the 22 residential lots within Phase I of this subdivision. The Benefit Assessment Act of 1982, Section 54703 et seq. of the Government Code, provides for the formation of assessment districts to fund the maintenance of the public streets and roadways.

**FISCAL IMPACT/FINANCING:**

No direct cost to the County will be incurred as the subdivider has paid the \$1,848 fee for formation of the assessment district.

The costs of this initiation action are limited to the costs of preparing the Engineer's Report and to notice the hearing. The costs to maintain improvements and administer the district will be presented in the Engineer's Report and will be proposed to be financed by the assessments collected.

**LINKAGE TO THE COUNTY OF TULARE STRATEGIC BUSINESS PLAN:**

The County's five-year strategic plan includes the Safety and Security initiative to provide for the safety and security of the public. The formation of this assessment district helps fulfill this initiative by ensuring and maintaining adequate roadways for the safety and protection of the public using the roadways in this subdivision.

**ALTERNATIVES:**

An alternative to formation of this assessment district to provide for public street and roadway maintenance may include requiring the Subdivider to form a homeowners association to provide for the maintenance of the public streets and roadways.

**INVOLVEMENT OF OTHER DEPARTMENTS OR AGENCIES:**

County Counsel assisted in preparing the various documents regarding these Assessment District formation procedures.

**SUBJECT:** 07-767-VISALIA  
**DATE:** November 27, 2007

**ADMINISTRATIVE SIGN-OFF:**

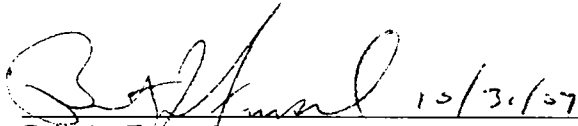
  
\_\_\_\_\_  
Britt L. Füssel  
Assistant Director - Engineering

  
\_\_\_\_\_  
Henry Hash  
Director

cc: Auditor/Controller  
County Counsel  
County Administrative Office (2)

Attachment(s)

**BEFORE THE BOARD OF SUPERVISORS  
COUNTY OF TULARE, STATE OF CALIFORNIA**

In the Matter of initiating proceedings for the Formation of Assessment District No. 07-767R-VISALIA of the County of Tulare, State of California, Pursuant to the Benefit Assessment Act of 1982 )  
 ) RESOLUTION NO. \_\_\_\_\_  
 ) AGREEMENT NO. \_\_\_\_\_  
 )  
 )

UPON MOTION OF SUPERVISOR \_\_\_\_\_, SECONDED BY SUPERVISOR \_\_\_\_\_, THE FOLLOWING WAS ADOPTED BY THE BOARD OF SUPERVISORS, AT AN OFFICIAL MEETING HELD ON NOVEMBER 27, 2007, BY THE FOLLOWING VOTE:

AYES:  
 NOES:  
 ABSTAIN:  
 ABSENT:

ATTEST: JEAN ROUSSEAU  
 COUNTY ADMINISTRATIVE OFFICER  
 CLERK, BOARD OF SUPERVISORS

BY: \_\_\_\_\_  
 Deputy Clerk

\* \* \* \* \*

1. Initiated proceedings to form Assessment District No. 07-767R-VISALIA.
2. Designated the County Engineer as the Engineer for the purpose of these proceedings.
3. Directed the Engineer to prepare and file a report with the Clerk of the Board.

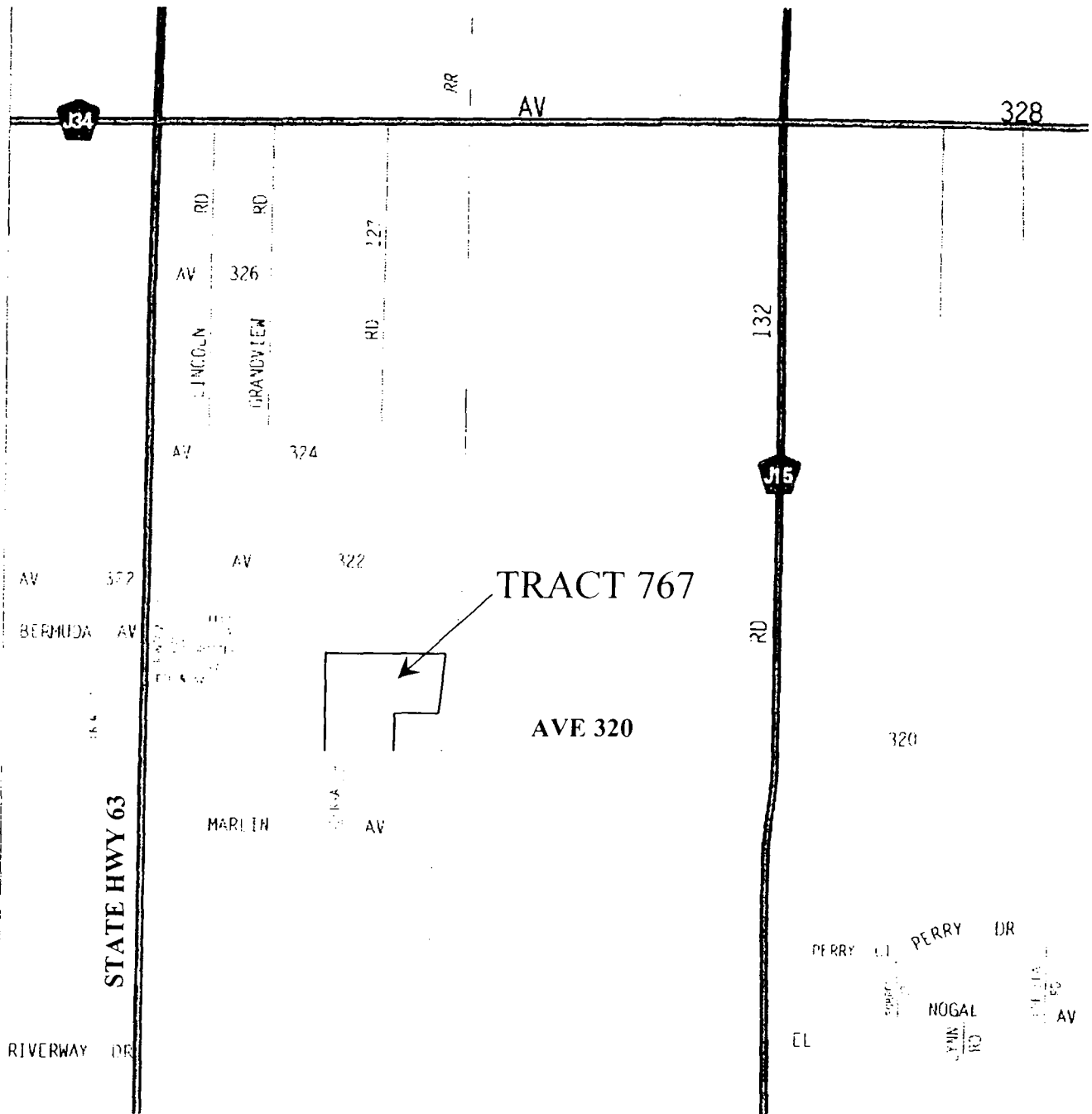

TRACT 767

AVE 320

STATE HWY 63

132

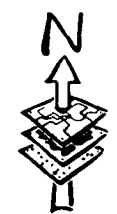

No Scale

LOCATION MAP