



**RESOURCE MANAGEMENT
AGENCY
COUNTY OF TULARE
AGENDA ITEM**

BOARD OF SUPERVISORS

ALLEN ISHIDA
District One

PLTE VANDER FOLL
District Two

PHILLIP A. COX
District Three

J. STEVEN WORTHLEY
District Four

MIKE ENNIS
District Five

AGENDA DATE: June 23, 2009

Public Hearing Required	Yes	<input type="checkbox"/>	No	<input checked="" type="checkbox"/>	N/A	<input type="checkbox"/>
Scheduled Public Hearing w/Clerk	Yes	<input type="checkbox"/>	No	<input type="checkbox"/>	N/A	<input checked="" type="checkbox"/>
Published Notice Required	Yes	<input type="checkbox"/>	No	<input type="checkbox"/>	N/A	<input checked="" type="checkbox"/>
Advertised Published Notice	Yes	<input type="checkbox"/>	No	<input type="checkbox"/>	N/A	<input checked="" type="checkbox"/>
Meet & Confer Required	Yes	<input type="checkbox"/>	No	<input checked="" type="checkbox"/>	N/A	<input type="checkbox"/>
Electronic file(s) has been sent	Yes	<input checked="" type="checkbox"/>	No	<input type="checkbox"/>	N/A	<input type="checkbox"/>
Budget Transfer (Aud 308) attached	Yes	<input type="checkbox"/>	No	<input type="checkbox"/>	N/A	<input checked="" type="checkbox"/>
Personnel Resolution attached	Yes	<input type="checkbox"/>	No	<input type="checkbox"/>	N/A	<input checked="" type="checkbox"/>
Resolution, Ordinance or Agreements are attached and signature line for Chairman is marked with tab(s)/flag(s) Yes <input checked="" type="checkbox"/> No <input type="checkbox"/> N/A <input type="checkbox"/>						

CONTACT PERSON: Celeste Perez PHONE: (559) 733-6291

SUBJECT: Amended Agreement with Shaw Environmental, Inc. (Shaw) for
Additional Design Work at the Woodville Landfill

REQUEST(S):

That the Board of Supervisors:

1. Approve an amendment to Tulare County Agreement No. 22809 with Shaw Environmental, Inc. to modify the Scope of Work, increase the contract amount from \$414,255 to \$678,125 and extend the term of the agreement from July 1, 2009 to December 31, 2017; and
2. Authorize the Chairman to sign the amended Agreement.

SUMMARY:

The County owns and operates the Woodville Landfill (Landfill) located on Road 152 near Avenue 200. The Landfill commenced operations in 1959, and has been in continuous operation since that time (Figure 1). The site originally contained fifty five and one half acres. In 1997, an eight acre lined cell was added in the south west corner of the site for a total of sixty three and one half acres referred to as Areas 1A (unlined) and 1B (lined) or collectively as WMU-1.

An additional eighty acres are planned for expansion directly south of WMU-1. This additional acreage is referred to as Area II (with phases A, B & C) or collectively as WMU-2 (Figure 2). A small portion in the northwestern half of this area is currently used as the site entrance and contains a scale and scale house, an office compound and employee parking area, an equipment staging area and a

SUBJECT: Amended Agreement with Shaw Environmental, Inc. (Shaw) for
Additional Design Work at the Woodville Landfill
DATE: June 23, 2009

recycling/salvage area. These areas and the entrance will eventually be relocated to other County owned property elsewhere on the site.

Title 27 of the California Code of Regulations governs solid waste facilities. Title 27 requires that any lateral expansion of a landfill must be over an area that is lined to prevent contamination of groundwater beneath the site. Title 27 also requires that landfills that have reached their capacity be closed or "capped" so as to prevent rainwater from entering the landfill. In addition, Title 27 requires that both of these activities (expansion and closure) be performed under the supervision of a Construction Quality Assurance Officer and personnel independent of the construction contractor and discharger (County).

On July 11, 2006, your Board entered into Agreement No. 22809 with Shaw Environmental, Inc. in the amount of \$414,255 to provide a closure and expansion design, perform a liner performance demonstration project, prepare an updated Report of Waste Discharge and provide construction quality assurance (CQA) services for the design and construction of the phased expansion and closure of the Woodville Solid Waste Disposal Site.

At the time the County entered into the Agreement with Shaw, it was believed that three years would be enough time to design and construct the first phase of the WMU-2 expansion and the partial final closure of WMU-1. Review and approval of various engineering studies and reports submitted to the Regional Water Quality Control Board (RWQCB) have taken over one year at this time. Because of these delays, successive parts of the design could not be completed in the timeframe initially proposed by Shaw.

At this time, based on the current approved final shape, it is estimated that WMU-1 at the Woodville Landfill will reach capacity in less than 2 years.

In an effort to provide uninterrupted service at the Woodville Landfill, staff has been working with Shaw to develop a new final grading plan for the surface of WMU-1 (Figure 3). Once regulatory approvals are obtained, this change will increase the capacity of WMU-1 by approximately 1 million cubic yards, increase the life of WMU-1 by approximately 5 years, and can be accomplished without exceeding the current permitted maximum elevation of WMU-1 while maintaining minimum grades and slopes required by regulations. Based on the recent actual cost of construction per cubic yard of landfill volume at the Visalia Landfill, this additional capacity represents a value to the County of approximately \$3.3 million.

As mentioned previously, there are approximately 2 years of capacity remaining in WMU-1 with the existing final grading plan. The new grading plan will add approximately 5 additional years of capacity at the current rate of disposal. The potential for an additional 7 years of capacity in WMU-1 would result in the construction of the final closure commencing sometime in 2016. Additional time

SUBJECT: Amended Agreement with Shaw Environmental, Inc. (Shaw) for Additional Design Work at the Woodville Landfill

DATE: June 23, 2009

after the completion of closure construction to prepare CQA certification and obtain regulatory approvals of the closure construction will also be required. Because Shaw is the designer of the new final closure plan for WMU-1, it is desirable that Shaw remain the CQA consultant during construction of the closure of the unit. Agreement No. 22809 with Shaw expires on July 10, 2009. Staff recommends that the expiration of Agreement No. 22809 with Shaw be extended to December 31, 2017.

While the proposed increase to the capacity of WMU-1 will exceed the current permitted capacity, it will remain well under the 36 million cubic yard capacity cited in the adopted 1996 Environmental Impact Report. Depending on the future waste stream, this increased capacity will add up to five years of additional service life to WMU-1 maximizing an existing resource while providing the time needed to complete the construction of a Phase 1 expansion in WMU-2. The additional capacity will be part of a permit revision when the Resource Management Agency (RMA) submits the revised Joint Technical Document and the Closure/Post-Closure Maintenance Plans. The regulatory agencies will need to approve the requested permit revisions.

Work done to date by Shaw includes:

- Completion of a liner performance demonstration resulting in approval of the use of a geosynthetic single composite liner system in the WMU-2 expansion area instead of a double composite liner system resulting in a construction cost savings of \$3.3 million for the 37 acre Phase 1 expansion;
- Completion of engineering studies and approval of a design report for the use of an evapotranspirative soil cover on the existing WMU-1 eliminating the need for installation of a geosynthetic clay liner as part of the WMU-1 closure resulting in a closure construction savings of approximate \$1.95 million; and
- Approximately 90% plans and specifications for the partial final closure of WMU-1 and the Phase I expansion of WMU-2.

Additional work outside the 2006 Scope of Work that Shaw will be performing includes:

- Completion of the design of the new final grading plan for the surface of WMU-1 discussed previously;
- Design of a WMU-2 liner system now that will accommodate future additional waste capacity not in the current design when the County has sufficient permitted acreage for the increased soil borrow necessary;
- Providing CQA services for an increased WMU-2 expansion area and the complete final closure of WMU-1; and
- Revising the plans and specifications for construction of Phase 1 of the WMU-2 expansion separate from construction of the final closure of WMU-1.

Staff recommends that your Board approve the amendment to Tulare County Agreement No. 22809 with Shaw Environmental, Inc.

SUBJECT: Amended Agreement with Shaw Environmental, Inc. (Shaw) for
Additional Design Work at the Woodville Landfill

DATE: June 23, 2009

The RMA will return to the Board of Supervisors for approval of the final plans, specifications and estimate and for authorization to advertise and construct the Woodville Expansion Project.

FISCAL IMPACT/FINANCING:

There is no net impact to the General Fund as this project is funded through tipping fees collected at the landfills. Funding has been budgeted under line item 045-235-2000-2150. The additional funding amount needed is included in the proposed fiscal year 2009-2010 budget.

LINKAGE TO THE COUNTY OF TULARE STRATEGIC BUSINESS PLAN:

The requested action assists the County in its efforts to manage its natural resources in addition to providing for the health and safety of the general public through environmental protection.

ALTERNATIVES:

Do not expand the Woodville Landfill and close the existing Landfill when it reaches capacity. This alternative is not recommended since the project will provide needed landfill capacity as the County continues to grow.

INVOLVEMENT OF OTHER DEPARTMENTS OR AGENCIES:

County Counsel has reviewed and approved the Amended Agreement as to form.

ADMINISTRATIVE SIGN-OFF:

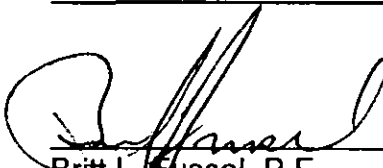
 6/23/09
Britt L. Fussel, P.E.
Assistant Director—Engineering
County Surveyor

cc: Auditor/Controller
County Counsel
County Administrative Office (2)

Attachment(s): Figures 1 through 3
Amended Agreement

**BEFORE THE BOARD OF SUPERVISORS
COUNTY OF TULARE, STATE OF CALIFORNIA**

IN THE MATTER OF AN AMENDED AGREEMENT WITH SHAW ENVIRONMENTAL, INC. FOR ADDITIONAL DESIGN WORK AT THE WOODVILLE LANDFILL))))))	RESOLUTION NO. _____ AGREEMENT NO. _____
--	----------------------------	---

UPON MOTION OF SUPERVISOR _____, SECONDED BY
SUPERVISOR _____, THE FOLLOWING WAS ADOPTED BY THE
BOARD OF SUPERVISORS, AT AN OFFICIAL MEETING HELD JUNE 23, 2009, BY
THE FOLLOWING VOTE:

AYES:
NOES:
ABSTAIN:
ABSENT:

ATTEST: JEAN M. ROUSSEAU
COUNTY ADMINISTRATIVE OFFICER/
CLERK, BOARD OF SUPERVISORS

BY: _____
Deputy Clerk

* * * * *

1. Approved an amendment to Tulare County Agreement No. 22809 with Shaw Environmental, Inc. to modify the Scope of Work, increase the contract amount from \$414,255 to \$678,125 and extend the term of the agreement from July 1, 2009 to December 31, 2017; and
2. Authorized the Chairman to sign the amended Agreement.

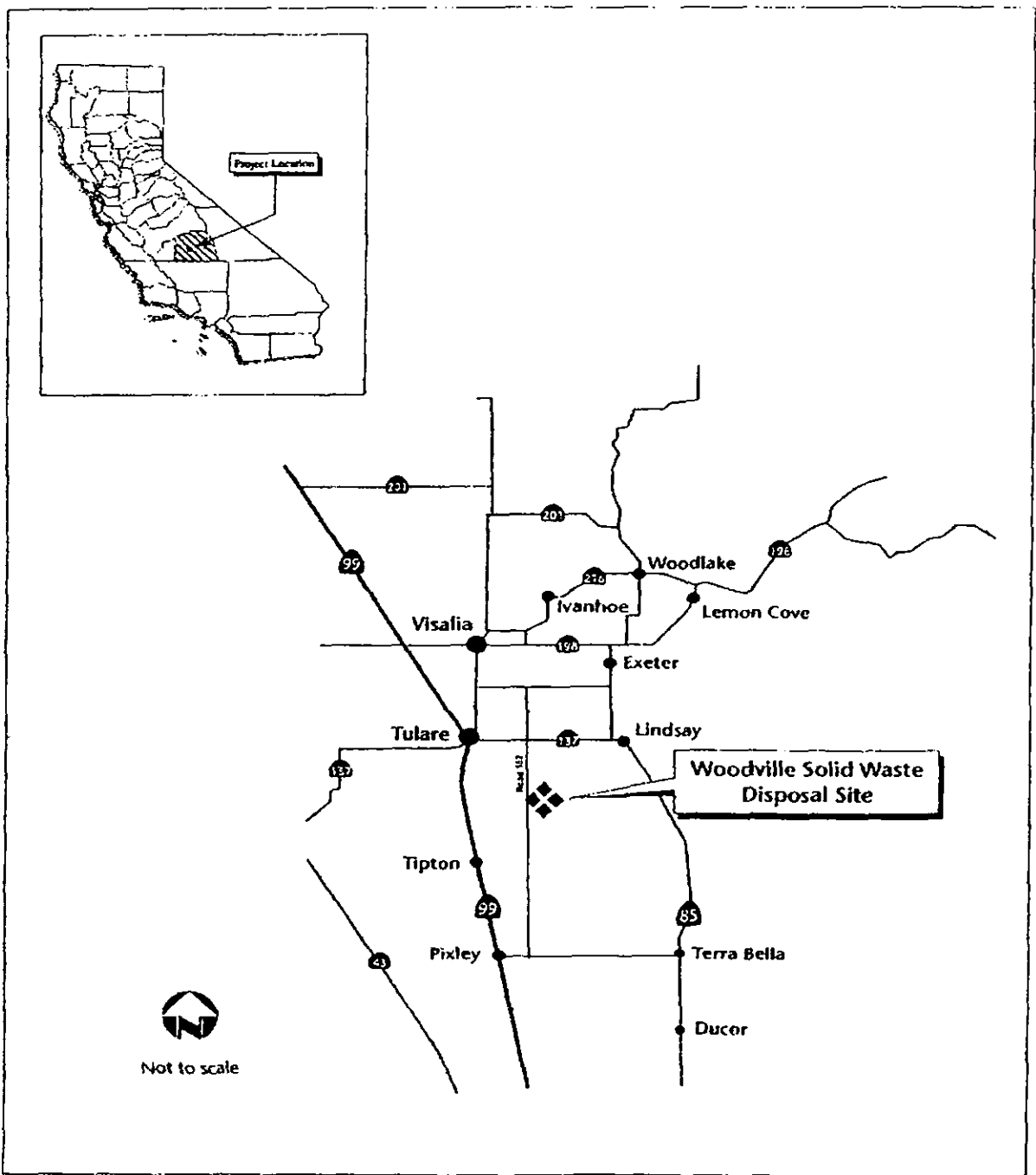

Figure 1
Woodville Solid Waste Disposal Project Location

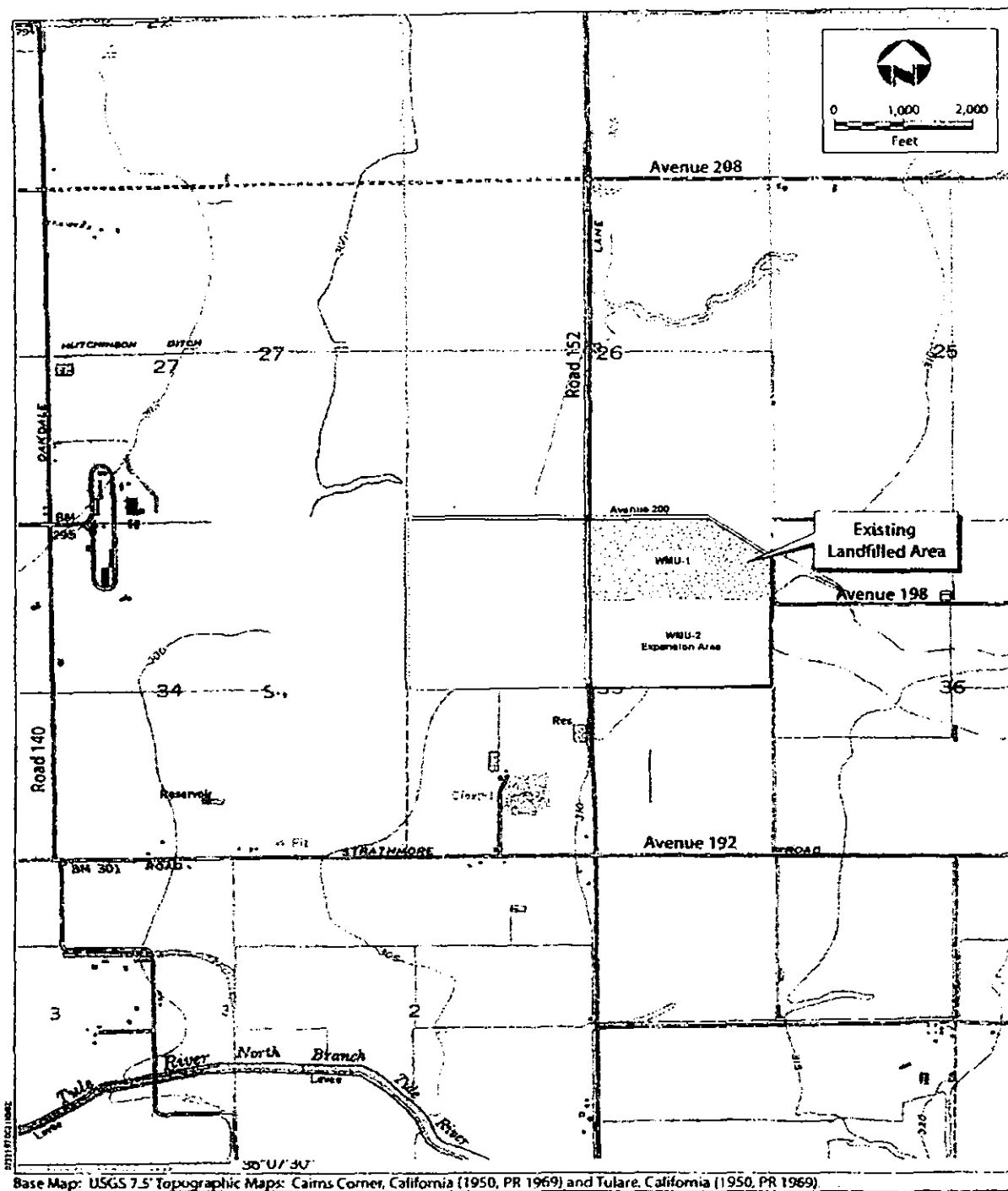

Figure 2
Woodville Solid Waste Disposal Site Location

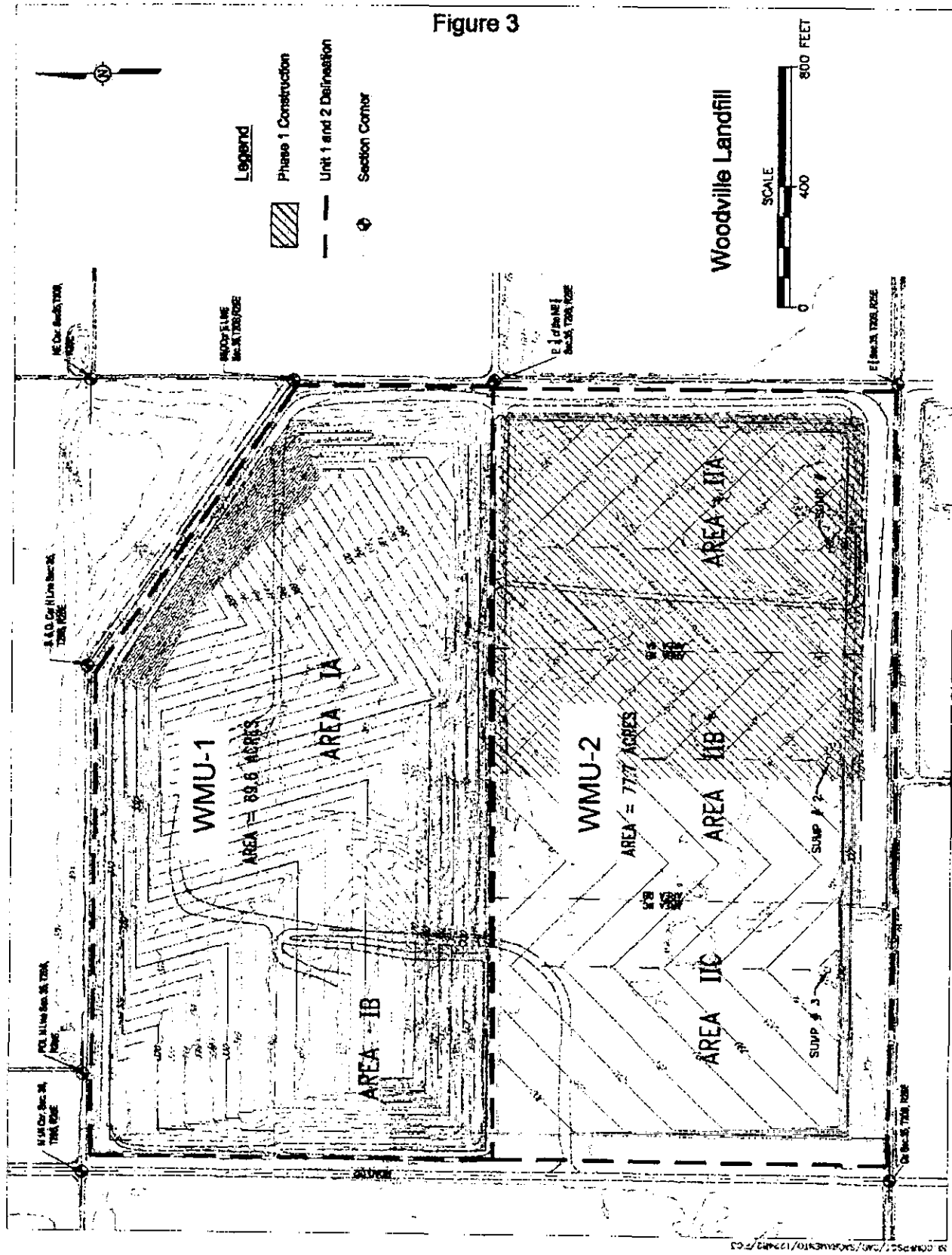

Figure 3